

# ***HYPERPRO***

***Suspension Technology***

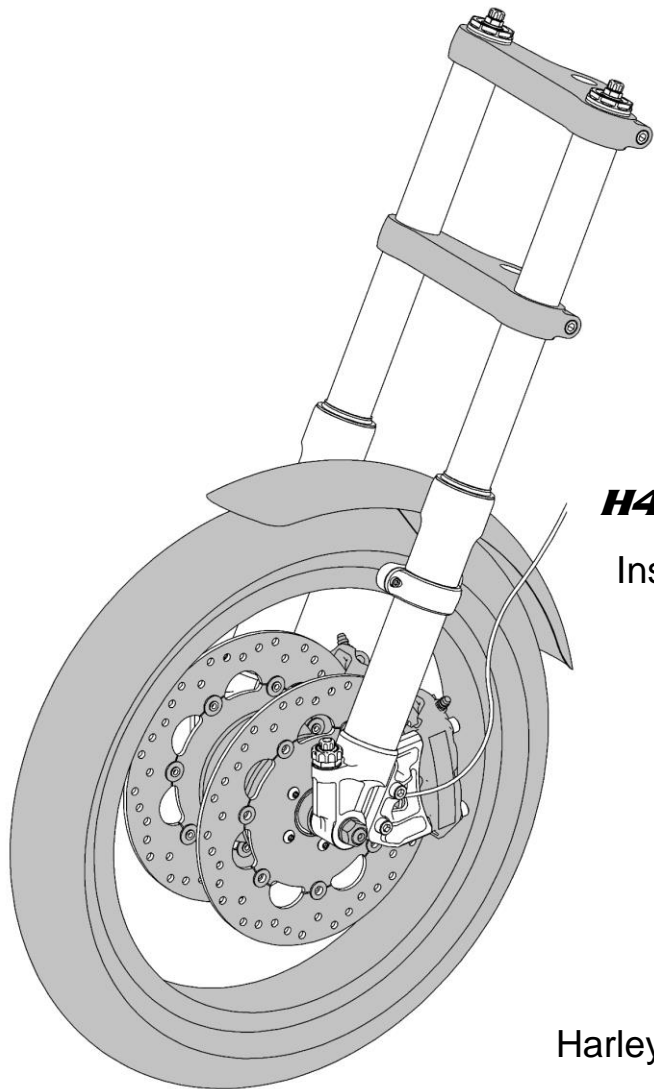

## ***H49 Front Fork***

Installation manual

Harley Davidson Dyna

(49mm fork / 300mm disc)

Street Bob `06-`17 / Low Rider (S) `06-`17

For removal and fitment of original parts, please refer to your motorcycle's service manual.

1

Make sure the bike is secure and lift the front.

Remove the front fender, brake caliper(s) and front wheel according to your vehicles workshop manual. Loosen the triple clamp bolts and remove the original fork legs from the bike.

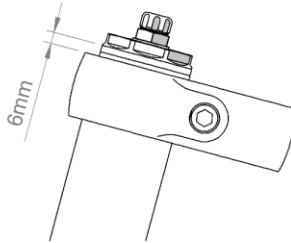

2

Insert the Hyperpro fork legs into the triple clamps. Set the edge of the fork tube 6mm above the upper triple clamp and tighten the clamp bolts.

Mount the fender brackets to the Hyperpro fork legs, use the centre groove for the original fender height.

*\*optionally the fender bracket can be fitted a groove higher or lower to accommodate a larger or smaller wheel size.*

Tighten the rear countersunk bolt first, then clamp using the front bolt.

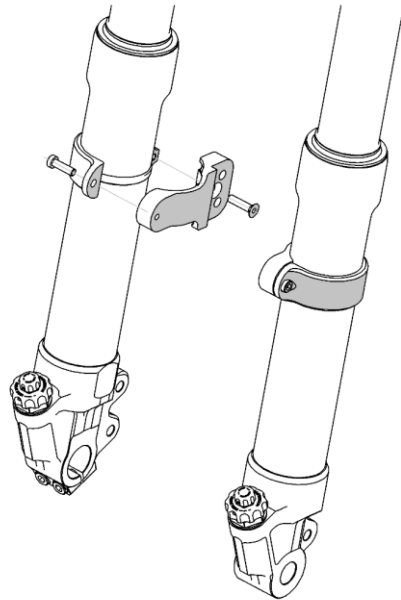

3

Mount the front wheel, front axle, axle washer and axle nut according to your vehicles workshop manual.

Before fully tightening, check the position of the ABS sensor (see picture 4a).

After assembly has completed, loosen the axle clamp bolts, push down on the forks firmly at least 5 times and re-tighten the clamp bolts.

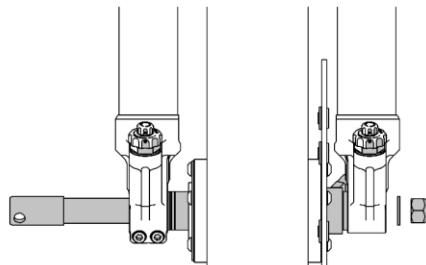

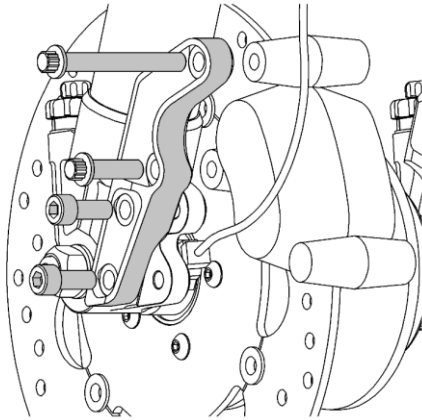

4

4a - OEM caliper(s): mount the brake adapter(s) to the fork legs, use the supplied bolts. Mount the brake caliper according to your vehicles service manual, using the original bolts.

4b - Radial caliper(s): loosen the ABS sensor cable at the connector under the tank. Guide the cable through the left brake adapter (see picture) and mount the brake adapter(s) to the fork legs, use the supplied bolts. Mount the brake caliper(s) to the adapters. Add caliper spacers for oversize disc(s).

Add shims behind the brake adapter where necessary to improve alignment of the caliper to the disc.

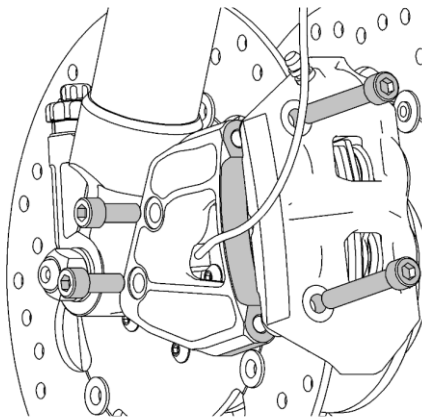

5

Check the routing of the ABS cable. Use zip ties to mount the cable away from moving parts (e.g. to the brake line).

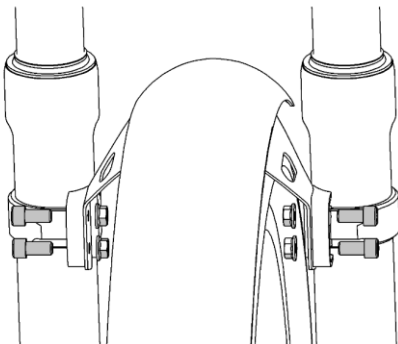

6

Install the fender to the fender brackets according to the workshop manual.

Adjust the angle of the fender bracket if necessary, by loosening only the front clamp bolt (do not forget to re-tighten).

**Torque settings**

**[Nm]**

Upper triple clamp bolt	19*
Lower triple clamp bolt	15*
Fender bracket bolts M6	5-9
Axle clamp bolts	18-20
Brake adapter bolts	38
Radial caliper bolts	38

\*for OEM torque specs, please consult your motorcycle's service manual

**Base settings**

Fork Length	815 mm
Stroke	130 mm
Spring free length	367.5 mm
Spring number	1152
Preload spacer	210
Preload setting (0-15mm)	7.5mm (15 clicks)
Fork oil	GP5
Air chamber	140mm
Rebound	15 clicks open
Compression Low speed	15 clicks open
Compression High speed	15 clicks open

**Accessories for Dyna:**

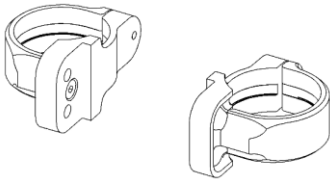

830-101-XX\* Fender bracket set (L+R)

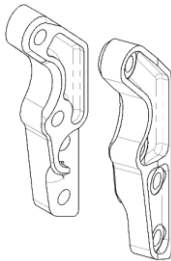

831-105-XX\* Brake adapter OEM L

831-106-XX\* Brake adapter OEM R

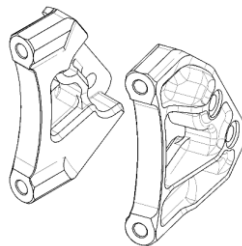

831-107-XX\* Adapter Radial 100mm L

831-108-XX\* Adapter Radial 100mm R

*Each brake adapter comes with 2 bolts and 4 shims. Hyperpro brake adapters are designed for original 300mm discs. Spacers are available for radial calipers to suit larger discs.*

\*("XX" = color: "B0" = Black / "S0" = Silver)